

SITE PLAN REVIEW AGENDA
Wednesday, September 18, 2024
1:30 PM
City of Tulare

ITEM No. 1 Preliminary Site Plan Review
Site Plan No SP 24-060
Project Title First Student Inc
Description install sand/oil separator and trench drain

Applicant David Gonzalez
Property Owner Dan Freitas
APN 191-290-016
Location 4770 S. K St

ITEM No. 2 Preliminary Site Plan Review
Site Plan No SP 24-061
Project Title Cecelia Sanchez (applicant)
Description fencing around vacant lot

Applicant Cecelia Sanchez
Property Owner Cecelia Sanchez
APN 176-126-004
Location behind postal office (340 E. Tulare Ave)

ITEM No. 3
Site Plan No
Project Title
Description

Applicant
Property Owner
APN
Location

ITEM No. 4
Site Plan No
Project Title
Description

Applicant
Property Owner
APN
Location



-- THIS AREA FOR CITY STAFF USE ONLY --

Date Received: _____

SPR Agenda: _____ Item No: _____

Zoning: _____ GP Designation: _____

CITY OF TULARE SITE PLAN REVIEW APPLICATION

This application **MUST** be filled out in its entirety and submitted with **ten (10) copies** of an acceptable site plan (see details below). Failure to provide all requested information may result in your application being rejected for additional information and excluded from the Site Plan Review agenda.

All plans to be considered on the next available agenda must be submitted by 3:00pm on the Thursday prior to the meeting.

SITE PLAN MEETINGS ARE HELD ON WEDNESDAYS AT 1:30 PM AT TULARE CITY HALL-COMMUNITY ROOM - 411 E KERN AVE - APPLICANT OR REPRESENTATIVE MUST BE PRESENT

GENERAL PROJECT INFORMATION

Project/Business Name: First Student, Inc Date: 9-10-24

Project Description: Install Sand/oil Separator & trench Drain to wash busses with pressure washer

Site Plan Review Submittal: Yes No If Resubmittal, Previous Site Plan Review No: _____

Property Owner: Dan Freitas Applicant(s) Name: David Gonzalez

Property Address/Location: 4770 S. K. Street Assessor Parcel No. (APN): 191290016

Parcel Size (Acreage or Sq Ft.): 4.629 Building Square Footage: 204,426

Describe All Proposed Building Modifications: Install 2urn trench Drain & Striem oil Sand Separator.

A SEPARATE DETAILED OPERATIONAL STATEMENT IS HIGHLY RECOMMENDED FOR ALL SUBMITTALS

Industrial & Commercial

Existing/Prior Land or Building Use: _____

Proposed Building or Land Use: _____

Proposed Hours of Operation: 6-5 Days of Week in Operation (Circle): Su M T W Th F Sa

Number of Existing Parking Stalls: _____ Number of Proposed New Parking Stalls: _____

Number of Existing or Anticipated New Employees: 40 Anticipated No. of Trucks/day: 83

Brief Operational Statement: Anticipated 4-7 Washes a Day for short busses & 100 gallons of water

Community & Economic Development Department
411 East Kern Avenue
Tulare, CA 93274
(559) 684.4217 Fax (559) 685.2339



— THIS AREA FOR CITY STAFF USE ONLY —
Date Received: _____
SPR No. _____
APPROVED:
By: _____ Date: _____
(Signature)

AGENCY AUTHORIZATION – Site Plan Review

OWNER:

I, Dan Freitas, declare as follows:
(Owners Name)

I am the owner of certain real property bearing Assessor's Parcel Number (APN):

4770 S. K. ST 191290016

AGENT:

I designate David Gonzalez, to act as my duly authorized agent for all purposes
(Agent's Name)

necessary to file an application for, and obtain a permit to:

Install trench drain & oil water separator
(Action Sought)

relative to the property mentioned herein.

I declare under penalty of perjury the foregoing is true and correct.

Executed this 10 day of sep, 20 24.

<u>OWNER</u>	<u>AGENT</u>
 (*Signature of Owner)	 (Signature of Agent)
<u>Dfreitas@danfreitasclotvic.com</u> (Owner Mailing Address)	<u>1809 S. K. Street</u> (Agent Mailing Address)
<u>983 E. Levin Tulare</u>	<u>Tulare CA. 93274</u>
<u>559-200-0478</u> (Owner Telephone)	<u>559-623-7469</u> (Agent Telephone)

*NOTE: OWNER'S SIGNATURE MUST BE NOTARIZED. Attach Acknowledgment of signature(s) by Notary Public.

A SEPARATE DETAILED OPERATIONAL STATEMENT IS HIGHLY RECOMMENDED FOR ALL SUBMITTALS

Residential

Is the project: New construction Remodel

Single-Family Residential Multi-Family Residential

Number of dwelling units: _____ Total of area (in square feet): _____

Total lot coverage of buildings or structures (in square feet): _____ Percentage of lot coverage _____%

Proposed project phasing: Yes No If yes, proposed number of phases: _____

SITE PLAN MINIMUM REQUIREMENTS

The Applicant shall submit **ten (10) copies** of the proposed site plan along with this completed Application to the Office of Community & Economic Development. Suggested minimum sheet size for site plans is 11"x17" folded to a legal size of 9"x12" with the print on the outside. No rolled plans accepted. (Excludes tentative and parcel maps)

The Site Plan shall be drawn to scale and indicate clearly and with full dimensions the following information: (*Municipal Code Section 10.120.040*)

- | | |
|--|--|
| <ul style="list-style-type: none"> ✓ Address ✓ Assessor's parcel number ✓ Vicinity map on cover sheet ✓ Scale and north arrow ✓ Dimensions of property ✓ Existing and proposed structures showing distances from Property lines ✓ Location and height of proposed fences, walls ✓ Existing and proposed parking stalls (include ADA) | <ul style="list-style-type: none"> ✓ Location and width of drive approaches ✓ Method of on-site drainage ✓ Location of existing and/or proposed public improvements ✓ Method of sanitary disposal ✓ Location and wide of drive approaches to site ✓ Adjacent street names ✓ Existing and proposed landscaping ✓ Location of signs and size ✓ Elevations if required by City Planner |
|--|--|

Failure to provide all requested information my result in your application being rejected and excluded from the Site Plan Review agenda

Applicant Information (Final Comments will be mailed to the name and address provided below.)

***If signed by an authorized agent, an "Agency Authorization" must be completed for this application to be considered complete.**

Name: David Gonzalez
 Address: 1816 S. K. Street
 City, State, Zip: Tulare CA 93274
 Phone: 559-686-8665
 E-Mail: DGonzalez@morrislewin.com

Signature of Owner or Authorized Agent*	
_____ Owner	_____ Date
 _____ Authorized Agent*	_____ Date 9-12-24

-THIS AREA FOR CITY STAFF USE ONLY-

APPLICATION DEEMED COMPLETE

By: _____

Date: _____

PERMA-TRENCH
IMPORTANT NOTE: The maximum temperature must not exceed 140°F (60°C). The operational variance should not exceed 80°F (25°C) within a 24 hr period. If there are any chemical, required flow rate, or temperature concerns, you will need to contact the Zurn factory at (855) 563-9876 for help designing your system.

LAYOUT HAS BEEN DEVELOPED FROM DRAWINGS OR SKETCHES SUBMITTED TO ZURN. PLEASE TAKE SOME TIME TO VERIFY OUR INTERPRETATION. NOTE: ALL PRICES SUBJECT TO CHANGE AT ANY TIME WITHOUT NOTICE.

DATE: _____

ACCEPT LAYOUT: _____

24JY29-3

LOAD RATING: DIMEN 1433 CLASS C

- CONTENT:**
- 1) COVER PAGE
 - 2) SPECS, DETAILS, BOM
 - 3-4) LAYOUT:
 - 5) INSTALL SHEET

PROJECT:

FIRST STUDENT

Z886-HD-DGC

REP AGENCY: **MAINLINE SALES, INC.**
 REP: **KYLIE PINETTE**
 CUSTOMER: **N/A**
 ORDER NUMBER: **N/A**



1-855-663-9876
 1-855-ONE-ZURN

<small>INSTALLATION: DO NOT SCALE DRAWING. ALL DIMENSIONS ARE AFTER FINISHING UNLESS NOTED. MINIMUM CLEARANCE: 2" (50mm) UNLESS NOTED. SEE SPECIFICATIONS FOR MATERIALS AND FINISHES. SEE SPECIFICATIONS FOR MATERIALS AND FINISHES. SEE SPECIFICATIONS FOR MATERIALS AND FINISHES.</small>		<small>PERMA-TRENCH® IS A REGISTERED TRADEMARK OF ZURN INDUSTRIES, LLC. © 2018</small>	
<small>PROJECT NO.</small> 2886	<small>DATE</small> 07/30/24	<small>SCALE</small> NONE	<small>REVISION</small> 1 of 5
<small>PROJECT NAME</small> Z886 TRENCH	<small>PROJECT NO.</small> 2886	<small>SCALE</small> NONE	<small>REVISION</small> 1 of 5
<small>PROJECT NO.</small> 2886	<small>DATE</small> 07/30/24	<small>SCALE</small> NONE	<small>REVISION</small> 1 of 5
<small>PROJECT NAME</small> Z886 TRENCH	<small>PROJECT NO.</small> 2886	<small>SCALE</small> NONE	<small>REVISION</small> 1 of 5
<small>PROJECT NO.</small> 2886	<small>DATE</small> 07/30/24	<small>SCALE</small> NONE	<small>REVISION</small> 1 of 5
<small>PROJECT NAME</small> Z886 TRENCH	<small>PROJECT NO.</small> 2886	<small>SCALE</small> NONE	<small>REVISION</small> 1 of 5
<small>PROJECT NO.</small> 2886	<small>DATE</small> 07/30/24	<small>SCALE</small> NONE	<small>REVISION</small> 1 of 5
<small>PROJECT NAME</small> Z886 TRENCH	<small>PROJECT NO.</small> 2886	<small>SCALE</small> NONE	<small>REVISION</small> 1 of 5

PERMA-TRENCH
IMPORTANT NOTE: The maximum temperature must not exceed 140°F (60°C).
 The operational variance should not exceed 80°F (26°C) within a 24 hr period. If there are any chemical, required flow rate, or temperature concerns, you will need to contact the Zurn factory at (955) 653-9876 for help designing your system.

LAYOUT HAS BEEN DEVELOPED FROM DRAWINGS OR SKETCHES SUBMITTED TO ZURN. PLEASE TAKE SOME TIME TO VERIFY OUR INTERPRETATION.
 NOTE: ALL PRICES SUBJECT TO CHANGE AT ANY TIME WITHOUT NOTICE.
 DATE: _____
 ACCEPT LAYOUT: _____

24JY29-3
 LOAD RATING: DIN/EN 1433 CLASS C

Z886-HD-DGC Bill of Material

TO Run	Line #	Channel Length	Channel Quantity	Total Length	Channel Frame	Grade	Grate QTY	Grate Cuts	QTY	Fabs	QTY	Outlets	Outlets	Options	Options
	Line 1	49.00	1	49.00	8932	+40	-DGC	2	04	1				E1	1
	Line 2	20.00	1	20.00	8933	+40	-DGC	1	04	1				E1	1
	Line 3	83.00	1	83.00	8937	+40	-DGC	4							
	Line 4	83.00	2	166.00	8934	+40	-DGC	8							
	Line 5	83.00	2	166.00	8935	+40	-DGC	8							
	Line 6	39.59	1	39.59	8934	+40	-DGC	2	04	1				JC	1
	Line 7	39.59	1	39.59	8934	+40	-DGC	2	04	1				JC	1
	TOTAL			54.97				32		3					3

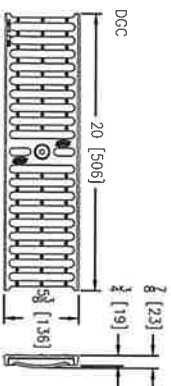
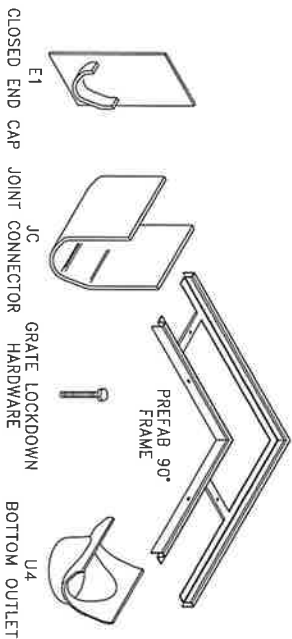
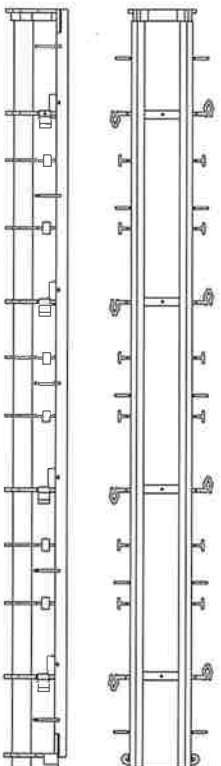

ENGINEERING SPECIFICATION: Zurn Z886-HD Channels are 80" [2032 mm] long, 6-3/4" [171 mm] wide reveal and have a 4" [102 mm] throat. Modular channel sections are made of 0% water absorbent High Density Polyethylene (HDPE). Channels have a positive mechanical connection between channel sections that will not separate during the installation and mechanically lock into the concrete surround every 10" [254 mm]. Channels weigh less than 2.31 lbs. [1.05kg] per linear foot, have a smooth, 1-1/2" [38 mm] radius self cleaning bottom with a Manning' coefficient of .009 and .75% or neutral 0% built in slope. Channels have rebar clips standard to secure trench in its final location. Channels provided with standard DGC grates that lock down to frame. Zurn 5.375" [137 mm] wide reveal Ductile Iron Slotted Grate conforming to ASTM specification A536-84, Grade 80-55-06. Ductile Iron grate is rated class C per the DIN EN1433 top load classifications. Supplied in 20" [508 mm] nominal lengths with 1/2" [13 mm] wide slots, and 3/4" [19 mm] bearing depth. Grate has an open area of 28.1 sq. in per ft. [59.463 sq. mm per meter]. The .105" [2.67 mm] thick Heavy-Duty Carbon Steel Frame Assembly conforms to ASTM specification A36 with 10 - 4" [102 mm] long concrete anchors per 80" [2032 mm]. Grate lockdown bars are to be integral to the frame. Frame supplied with powder coated finish. All welds must be performed by a certified welder per ASTM standard AWS D1.1. Frames produced in the U.S.A.

ZURN INDUSTRIES, LLC
 2100 PITTSBURGH AVE
 ERIE, PA 16502
 © 2018

ZURN

DESIGN ORIGINATOR: **AW**
 DATE: **07/26/24**
 SCALE: **A**
 DRAWING NO.: **2886 BOWL LAYOUT FOR FIRST STUDENT**
 PAGE NO.: **2 of 5**

REVISION: **-**

PERMA-TRENCH
IMPORTANT NOTE: The maximum temperature must not exceed 140°F (60°C).
 The operational variance should not exceed 60°F (26°C) within a 24 hr period. If there are any chemical, required flow rate, or temperature concerns, you will need to contact the Zurn factory at (855) 653-9876 for help designing your system.

LAYOUT HAS BEEN DEVELOPED FROM DRAWINGS OR SKETCHES SUBMITTED TO ZURN. PLEASE TAKE SOME TIME TO VERIFY OUR INTERPRETATION.
 NOTE: ALL PRICES SUBJECT TO CHANGE AT ANY TIME WITHOUT NOTICE.
 DATE: _____
 ACCEPT LAYOUT: _____

24JY29-3
 LOAD RATING: DIV/EN 1433 CLASS C

TD-1
QTY: 1
W/-HD-DGC

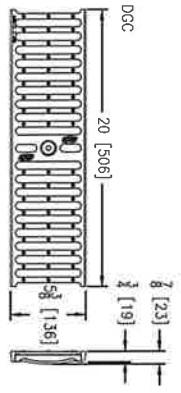
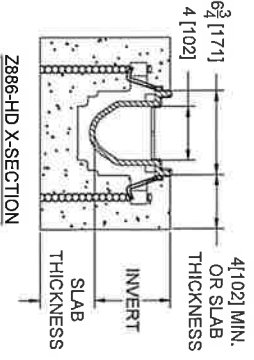
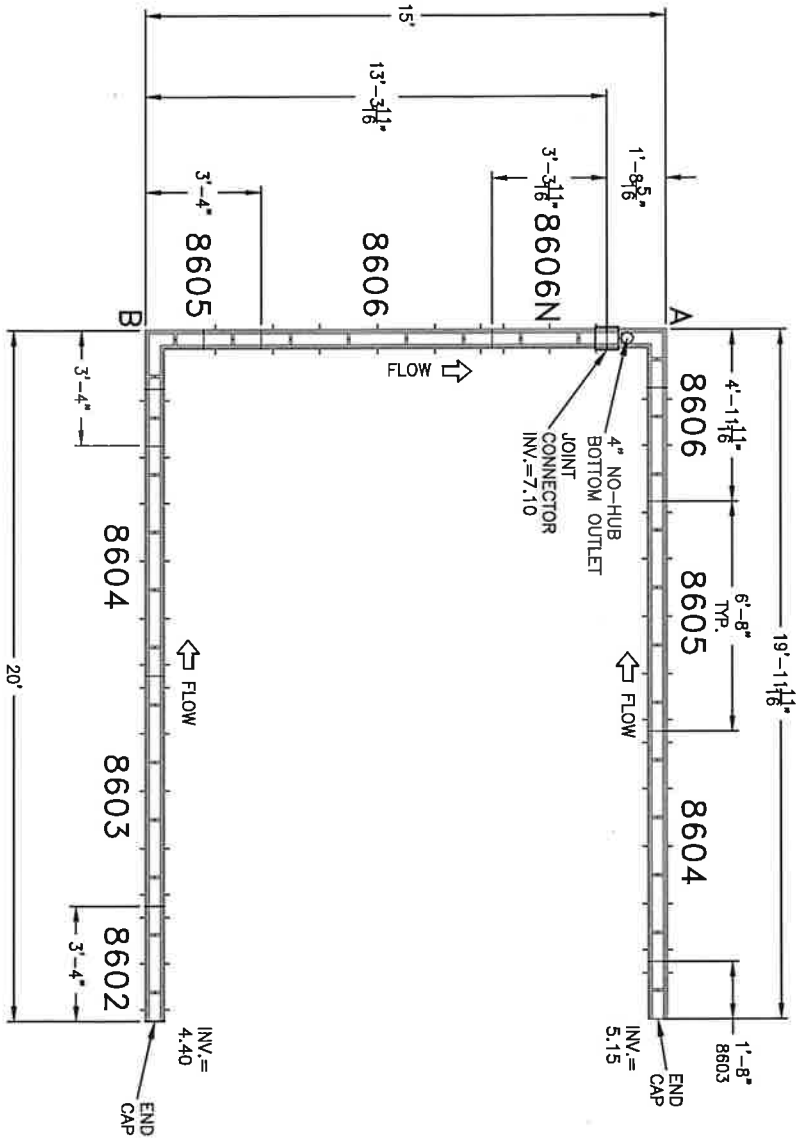

ZURN INDUSTRIES, LLC GROUP 1801 PITTSBURGH AVE ERIE, PA 16502 © 2016		ZURN INDUSTRIES, LLC GROUP 3 of 5
ZURN INDUSTRIES, LLC GROUP FIRST STUDENT	PROJECT NO. Z886 TRENCH LAYOUT FOR DATE: 07/30/24 SCALE: 1" = 1'-0" SHEET: A	PAGE NO.
ZURN INDUSTRIES, LLC GROUP 1801 PITTSBURGH AVE ERIE, PA 16502 © 2016	ZURN INDUSTRIES, LLC GROUP FIRST STUDENT	REVISION

PERMA-TRENCH
 IMPORTANT NOTE: The maximum temperature must not exceed 140°F (60°C).
 The operational variance should not exceed 50°F (25°C) within a 24 hr period. If there are any chemical, required flow rate, or temperature concerns, you will need to contact the Zurn factory at (855) 653-9876 for help designing your system.

LAYOUT HAS BEEN DEVELOPED FROM DRAWINGS OR SKETCHES SUBMITTED TO ZURN. PLEASE TAKE SOME TIME TO VERIFY OUR INTERPRETATION.
 NOTE: ALL PRICES SUBJECT TO CHANGE AT ANY TIME WITHOUT NOTICE.
 DATE: _____
 ACCEPT LAYOUT: _____

24JY29-3
 LOAD RATING: DIM/EN 1433 CLASS C

TD-1
QTY:1
W/-HD-DGC

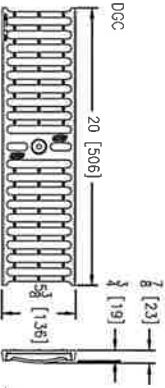
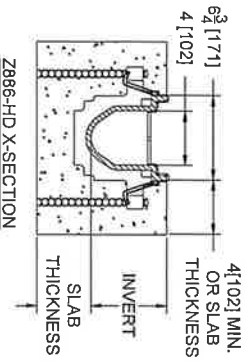
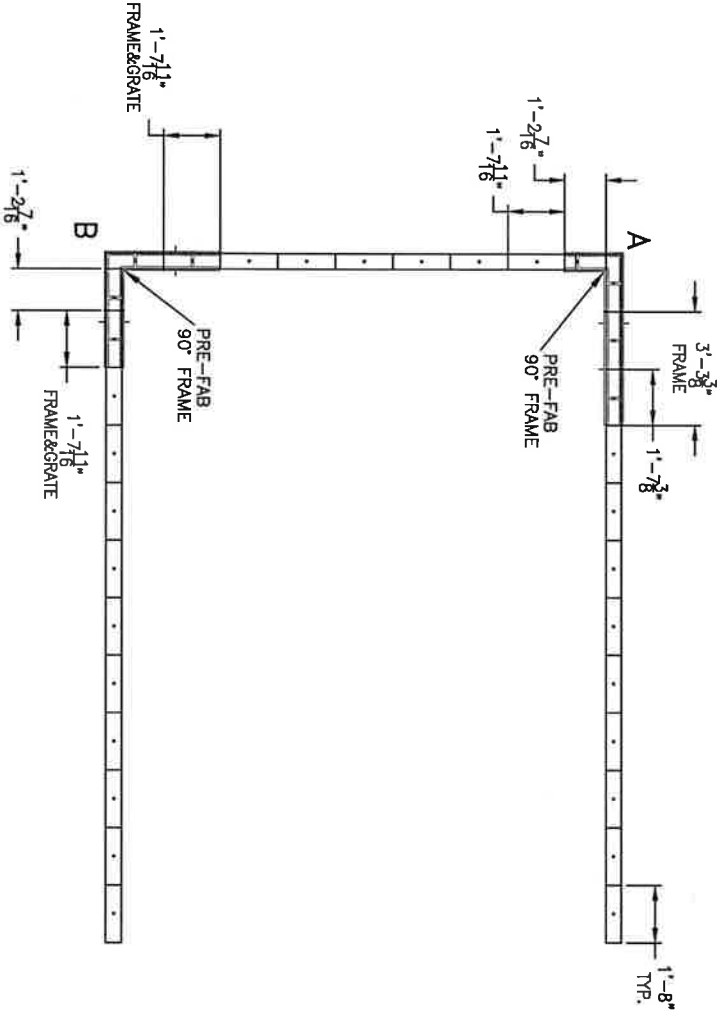

NOTES:
 1. ALL DIMENSIONS DENOTE CUT GRATES, EXCEPT WHERE NOTED OTHERWISE.

PERMANENT TRENCHING DIMENSIONS FOR PERMANENT TRENCHING

ALL DIMENSIONS ARE AFTER FINISHING UNLESS NOTED OTHERWISE

TRUCK GRATE EDGE & 6000 MAX. WELD SIZES ARE

ITEM	DESCRIPTION	UNIT	SCALE	DATE
1	PERMANENT TRENCHING DIMENSIONS FOR PERMANENT TRENCHING			

ZURN

ZURN INDUSTRIES, LLC
 1501 PITTSBURGH AVE
 ERIE, PA 16502
 ©2018

4 of 5

REVISION

PERMA-TRENCH
IMPORTANT NOTE: The maximum temperature must not exceed 140°F (60°C).
 The operational variance should not exceed 80°F (26°C) within a 24 hr period. If there are any chemical, required flow rate, or temperature concerns, you will need to contact the Zurn factory at (855) 663-9876 for help designing your system.

LAYOUT HAS BEEN DEVELOPED FROM DRAWINGS OR SKETCHES SUBMITTED TO ZURN. PLEASE TAKE SOME TIME TO VERIFY OUR INTERPRETATION.
 NOTE: ALL PRICES SUBJECT TO CHANGE AT ANY TIME WITHOUT NOTICE.
 DATE: _____
 ACCEPT LAYOUT: _____

24JY29-3
 LOAD RATING: DIMEN 1433 CLASS C

Locate the trench sections that are to receive any accessories, such as end caps, bottom outlets and/or end outlets. These accessories can be easily attached with a silicon caulking and/or sheet metal screws. Trim the end caps to the appropriate depth prior to attaching them to the trench sections.

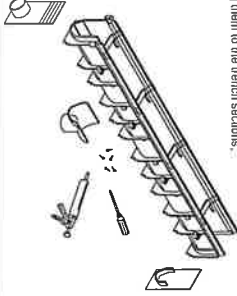

Trench excavation must be 4 inches greater than the trench depth and a minimum of 14 inches in width. Soft and/or stringy soil substitutes may cause cracking of the concrete and consequent movement of the trench. It is critical that the concrete be poured on an adequate foundation.

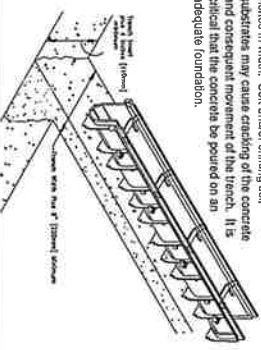

Assembling the trench unit is easy with Perma-Trench's unique mechanical joint interlock. Simply align the two mating ends of the trench sections and fasten with the hardware fasteners provided.

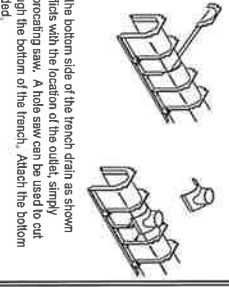

A bottom outlet is attached to the bottom side of the trench drain as shown above. If external ribbing conflicts with the location of the outlet, simply remove the ribbing with a reciprocating saw. A hole saw can be used to cut the appropriate size hole through the bottom of the trench. Attach the bottom outlet with the hardware provided.

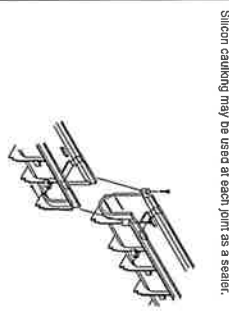

A joint connector (JC) is available to join two trench sections without the interlocking joint, such as sections that may be found in opposite directions. Cut the lengths and fasten the JC as shown. The connection can be sealed with a silicon caulking and held in place mechanically with the fasteners provided in the accessory assembly bag.

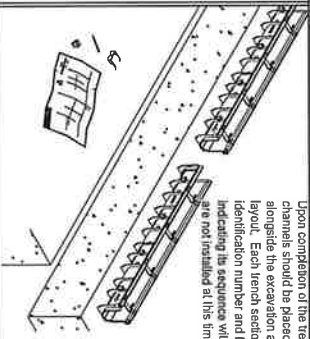

Upon completion of the trench excavation, the channels should be placed in numeric order alongside the excavation and according to the layout. Each trench section has a trench identification number and flow direction arrow indicating its sequence within the system. Grates are not installed at this time.

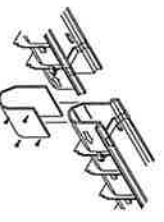

Shipping / Installation Bars will be placed on ALL channels with no frame attached prior to shipment. This is to stabilize the rails and maintain the inside dimensions during the shipping / installation bars are for shipping and installation purposes only and must be removed upon completion of the concrete pour.

(4) Shipping / Installation Bars per Channel, recommended spacing is approximately 2'-0" from end of rail (for center pieces), and 2'-9" from end of rail (for center pieces). All locations shipping / installation bars are approximate.

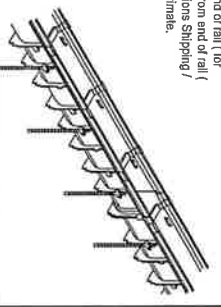

Remove shipping bars before attaching frame to channel.

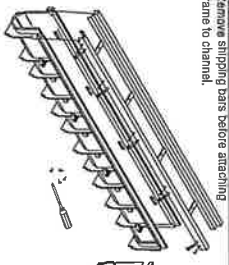

Perma-Trench offers a Heavy Duty (HD) frame option for intense traffic patterns. Simply slide the HD frame over the trench sections, as shown below and attach with the hardware provided. Make certain that the notched end of the frame is at the male end of each trench section.

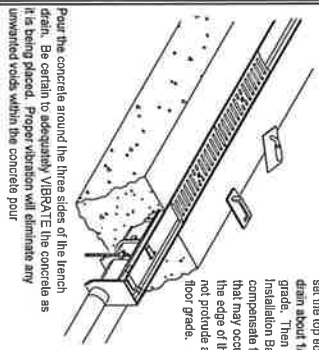

Pour the concrete around the three sides of the trench drain. Be certain to adequately VIBRATE the concrete as it is being placed. Proper vibration will eliminate any unwanted voids within the concrete pour.

Finish troweling should be done to set the top edge of the trench drain about 1/8" below the floor grade. Then remove Shipping / Installation Bars. Remember to compensate for concrete shrink that may occur during cure so that the edge of the trench drain does not protrude above the finished floor grade.

- ⚠ **WARNING:** Cancer and reproductive harm - www.P65Warnings.ca.gov.
 - ⚠ **ADVERTISMENT:** Cáncer y daño reproductivo - www.P65Warnings.ca.gov.
 - ⚠ **AVERTISSEMENT:** Cáncer y efectos reproductivos - www.P65Warnings.ca.gov.
- IMPORTANT ADDITIONAL NOTES:**
- Standard concrete practices shall be used in the installation and finishing of the concrete surrounding the Zurn System. Expansion and control joints should be installed as specified by the engineer.
 - For Class C rated and above grates place bolts in tapped holes to accommodate grate lockdown bolts if not installing grates at time of concrete pour.
 - This Install Sheet provides quick reference details ONLY. Visit www.Zurn.com for the complete installation instructions.

INSTALLATION INSTRUCTIONS: TO BE USED IN CONJUNCTION WITH PERMA-TRENCH SYSTEM. ALL DIMENSIONS ARE AFTER FINISHING UNLESS NOTED. BRICK SHARP EDGE FINISH. CONCRETE SHALL BE 3000 PSI MIN. (28 MPa) MINIMUM.

ITEM	DESCRIPTION	QTY	UNIT
1	PERMA-TRENCH SYSTEM	1	LINEAL FOOT
2	PERMA-TRENCH SYSTEM	1	LINEAL FOOT
3	PERMA-TRENCH SYSTEM	1	LINEAL FOOT
4	PERMA-TRENCH SYSTEM	1	LINEAL FOOT
5	PERMA-TRENCH SYSTEM	1	LINEAL FOOT
6	PERMA-TRENCH SYSTEM	1	LINEAL FOOT
7	PERMA-TRENCH SYSTEM	1	LINEAL FOOT
8	PERMA-TRENCH SYSTEM	1	LINEAL FOOT
9	PERMA-TRENCH SYSTEM	1	LINEAL FOOT
10	PERMA-TRENCH SYSTEM	1	LINEAL FOOT
11	PERMA-TRENCH SYSTEM	1	LINEAL FOOT
12	PERMA-TRENCH SYSTEM	1	LINEAL FOOT
13	PERMA-TRENCH SYSTEM	1	LINEAL FOOT
14	PERMA-TRENCH SYSTEM	1	LINEAL FOOT
15	PERMA-TRENCH SYSTEM	1	LINEAL FOOT
16	PERMA-TRENCH SYSTEM	1	LINEAL FOOT
17	PERMA-TRENCH SYSTEM	1	LINEAL FOOT
18	PERMA-TRENCH SYSTEM	1	LINEAL FOOT
19	PERMA-TRENCH SYSTEM	1	LINEAL FOOT
20	PERMA-TRENCH SYSTEM	1	LINEAL FOOT

ZURN
 ZURN INDUSTRIES, LLC
 PUMING PRODUCTS GROUP
 1801 FITZBURGH AVE
 PITTSBURGH, PA 15202
 © 2010

FIRST STUDENT
 Z886 INSTALL SHEET FOR
 5 OF 5
 REVISION

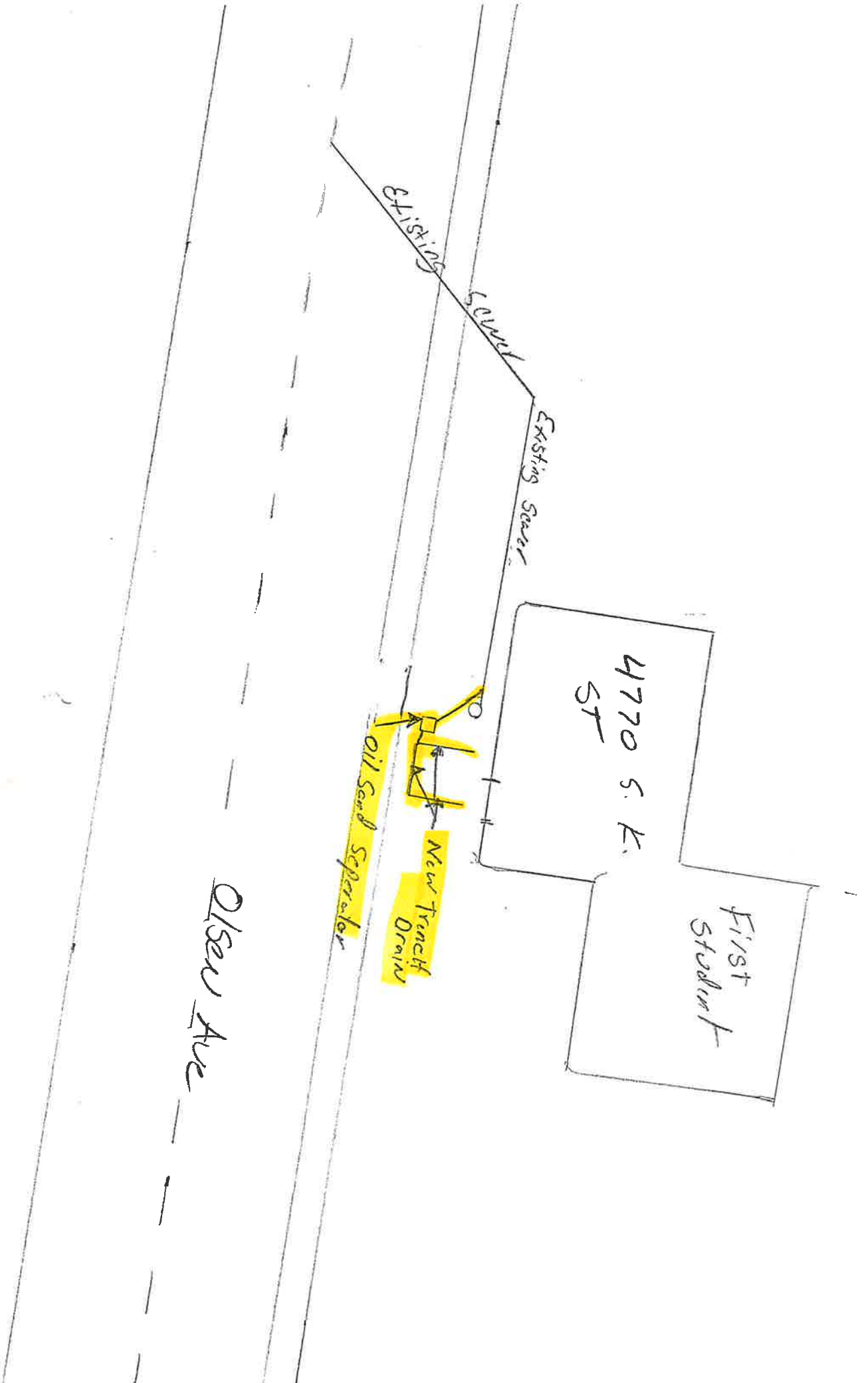

SPECIFICATIONS

1. 6" Plain End inlet/outlet shown, 3" Plain End vents standard.
2. Max flow rate: 314 GPM.
3. Liquid capacity: 562 gallons (75 cu. ft.).
4. Oil capacity: 285 gallons.
5. Solids capacity: 162 gallons.
6. Unit weight: 1025 lbs.
7. Maximum operating temperature 140°F continuous.

NOTES

1. For gravity drainage applications only.
2. Do not use for pressure applications.
3. Cover placement allows full access to tank for proper maintenance.
4. Lifting lug set for easy install.

ENGINEER SPECIFICATION GUIDE

Striem oil separator model OT-500 shall be lifetime guaranteed and made in the USA. Separator shall be constructed of polyethylene with 7/8" nominal wall thickness. Separator shall be manufactured for below-grade installation. Field-adjustable riser system is available as an option to bring manhole covers to grade. Separator flow rate shall be 314 GPM. Separator liquid holding capacity shall be 562 gallons and oil capacity shall be 285 gallons. Solids capacity shall be 162 gallons. Covers shall be H20 rated pickable cast iron. Separator shall be certified to IAPMO IGC 183-2016 and carry a UPC listing.

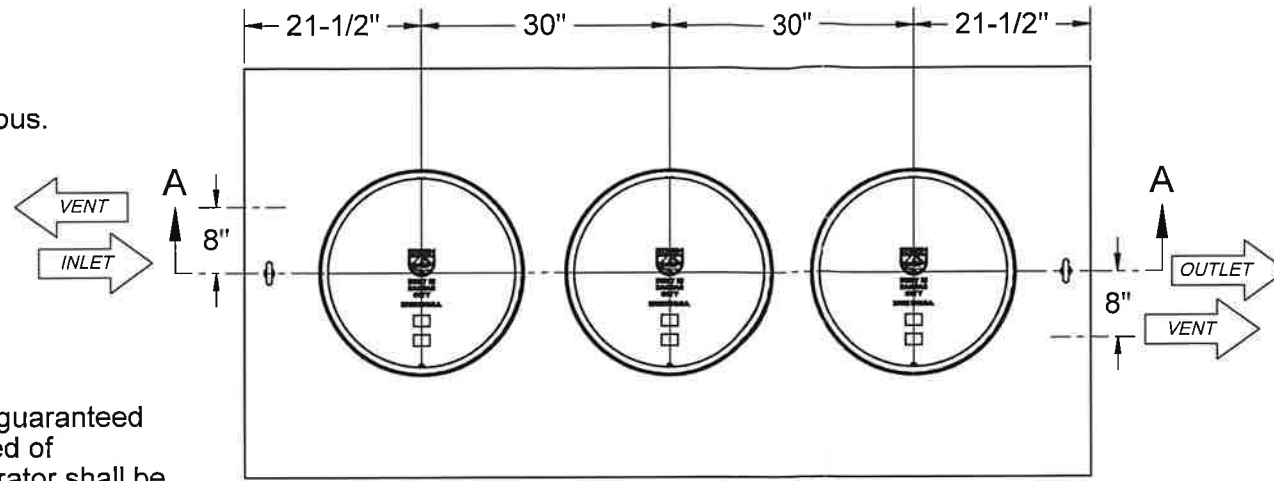

TOP VIEW

OPTIONS

Connection Options (Plain End Only)

Inlet / Outlet

- 4"
- 6"
- 8"

SELECTION
REQUIRED

Riser Options

From Factory: Up to 5"

- Up to 24": **SR24** (3)
- Up to 39": **LR24** (3)
- Up to 43": **SR24** (6)
- Up to 58": **SR24** (3) + **LR24** (3)
- Up to 72": **LR24** (6)
- Up to 90": **SR24** (3) + **LR24** (6)
- Up to 106": **LR24** (9)

- OR -

- CPRK** (3): 11" - 106" (See specification for more detail.)

Additional Options

- HDK-3**: High Water Table Hold Down Kit
- SS**: Slick Stick™ Oil Level Monitoring System*

*Monitoring system will raise covers by 3".

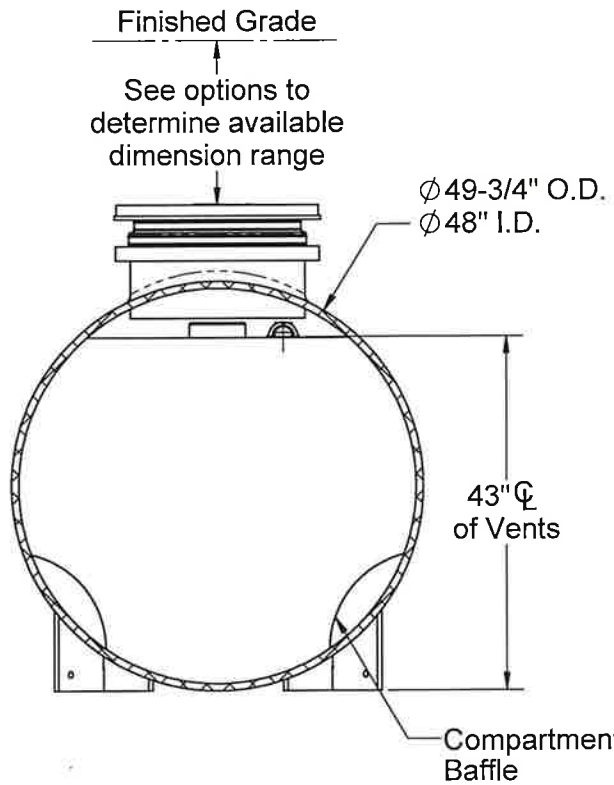

SECTION B-B

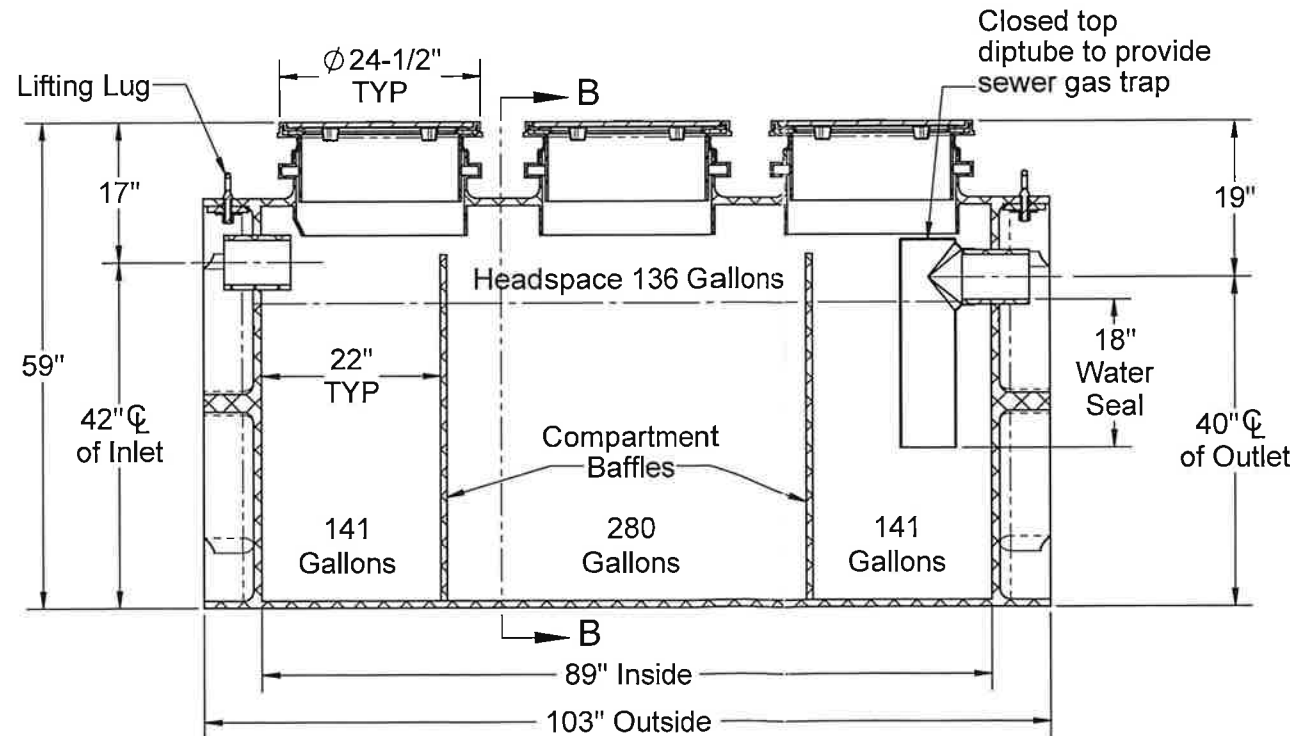

SECTION A-A

MODEL NUMBER: OT-500

DESCRIPTION:
OIL TANKER™
POLYETHYLENE OIL SEPARATOR
562 GALLON CAPACITY

SPECIFICATION SHEET

Striem
Kansas City, KS
Tel: 913-222-1500
orders@striemco.com



PO IS NON-CANCELABLE
ORDER IS NON-RETURNABLE

Community & Economic Development Department
411 East Kern Avenue
Tulare, CA 93274
(559) 684.4217 Fax (559) 685.2339

Fee: \$0.00

Site Plan Review Application No. 24-101



-- THIS AREA FOR CITY STAFF USE ONLY --

Date Received: _____

SPR Agenda: _____ Item No: _____

Zoning: _____ GP Designation: _____

CITY OF TULARE SITE PLAN REVIEW APPLICATION

*This application MUST be filled out in its entirety and submitted with **ten (10) copies** of an acceptable site plan (see details below). Failure to provide all requested information may result in your application being rejected for additional information and excluded from the Site Plan Review agenda.*

All plans to be considered on the next available agenda must be submitted by 3:00pm on the Thursday prior to the meeting.

SITE PLAN MEETINGS ARE HELD ON WEDNESDAYS AT 1:30 PM AT TULARE CITY HALL-COMMUNITY ROOM - 411 E KERN AVE - APPLICANT OR REPRESENTATIVE MUST BE PRESENT

GENERAL PROJECT INFORMATION

Project/Business Name: _____ Date: 9/12/24

Project Description: _____

Site Plan Review Submittal: Yes No If Resubmittal, Previous Site Plan Review No: _____

Property Owner: Cecilia Sanchez Applicant(s) Name: Cecilia Sanchez

Property Address/Location: vacant lot Assessor Parcel No. (APN): 176-126-004-00

Parcel Size (Acreage or Sq Ft.): 7,500 Sq Ft. Building Square Footage: _____

Describe All Proposed Building Modifications: put a fence around lot.

A SEPARATE DETAILED OPERATIONAL STATEMENT IS HIGHLY RECOMMENDED FOR ALL SUBMITTALS

Industrial & Commercial

Existing/Prior Land or Building Use: parking

Proposed Building or Land Use: not sure

Proposed Hours of Operation: _____ Days of Week in Operation (Circle): Su M T W Th F Sa

Number of Existing Parking Stalls: 24 Number of Proposed New Parking Stalls: 0

Number of Existing or Anticipated New Employees: _____ Anticipated No. of Trucks/day: _____

Brief Operational Statement: _____

A SEPARATE DETAILED OPERATIONAL STATEMENT IS HIGHLY RECOMMENDED FOR ALL SUBMITTALS

Residential

Is the project: New construction Remodel

Single-Family Residential Multi-Family Residential

Number of dwelling units: _____ Total of area (in square feet): _____

Total lot coverage of buildings or structures (in square feet): _____ Percentage of lot coverage _____%

Proposed project phasing: Yes No If yes, proposed number of phases: _____

SITE PLAN MINIMUM REQUIREMENTS

The Applicant shall submit **ten (10) copies** of the proposed site plan along with this completed Application to the Office of Community & Economic Development. Suggested minimum sheet size for site plans is 11"x17" folded to a legal size of 9"x12" with the print on the outside. No rolled plans accepted. (Excludes tentative and parcel maps)

The Site Plan shall be drawn to scale and indicate clearly and with full dimensions the following information: (*Municipal Code Section 10.120.040*)

- | | |
|--|--|
| <ul style="list-style-type: none"> ✓ Address ✓ Assessor's parcel number ✓ Vicinity map on cover sheet ✓ Scale and north arrow ✓ Dimensions of property ✓ Existing and proposed structures showing distances from Property lines ✓ Location and height of proposed fences, walls ✓ Existing and proposed parking stalls (include ADA) | <ul style="list-style-type: none"> ✓ Location and width of drive approaches ✓ Method of on-site drainage ✓ Location of existing and/or proposed public improvements ✓ Method of sanitary disposal ✓ Location and wide of drive approaches to site ✓ Adjacent street names ✓ Existing and proposed landscaping ✓ Location of signs and size ✓ Elevations if required by City Planner |
|--|--|

Failure to provide all requested information my result in your application being rejected and excluded from the Site Plan Review agenda

Applicant Information (Final Comments will be mailed to the name and address provided below.)

***If signed by an authorized agent, an "Agency Authorization" must be completed for this application to be considered complete.**

Name: Cecilia Sanchez
 Address: 1086 S. Amefjian St.
 City, State, Zip: Tulare, CA 93274
 Phone: (559) 827-2913
 E-Mail: Sanchez.cecilia79@yahoo.com

Signature of Owner or Authorized Agent*	
_____ Owner	_____ Date
_____ Authorized Agent*	_____ Date

-THIS AREA FOR CITY STAFF USE ONLY-

APPLICATION DEEMED COMPLETE

By: _____

Date: _____

Community & Economic Development Department
411 East Kern Avenue
Tulare, CA 93274
(559) 684.4217 Fax (559) 685.2339



— THIS AREA FOR CITY STAFF USE ONLY —

Date Received: _____

SPR No. _____

APPROVED: _____

By: _____ Date: _____

(Signature)

AGENCY AUTHORIZATION – Site Plan Review

OWNER:

I, Cecilia Sanchez, declare as follows:
(Owners Name)

I am the owner of certain real property bearing Assessor's Parcel Number (APN):

176-126-004-000

AGENT:

I designate _____, to act as my duly authorized agent for all purposes
(Agent's Name)

necessary to file an application for, and obtain a permit to:

put up a fence
(Action Sought)

relative to the property mentioned herein.

I declare under penalty of perjury the foregoing is true and correct.

Executed this 12 day of September, 20 24.

<u>OWNER</u>	<u>AGENT</u>
<u>Cecilia Sanchez</u> (*Signature of Owner)	_____ (Signature of Agent)
<u>6816 S. Armetjian St.</u> (Owner Mailing Address)	_____ (Agent Mailing Address)
<u>Tulare, CA 93274</u>	_____
<u>(559) 807-2913</u> (Owner Telephone)	_____ (Agent Telephone)

***NOTE: OWNER'S SIGNATURE MUST BE NOTARIZED. Attach Acknowledgment of signature(s) by Notary Public.**

Search here



Set home

Restaurants

Coffee

Gas

80°
45 AQI

E King Ave



Simplified Bookkeeping & Tax

Opus Escrow



Google



Assessor's Parcel Lookup



▼ 176-126-004 X 🔍

Show search results for 176-126...

Chavez
Farmers
Jurisdiction
Agency

021

E King Ave

N M St

002

003

004

005

007

N M St

100ft

-119.344 36.209 Degrees

Esri Community Maps Contrib...



AA

🔒 portal.tularecounty.ca.gov



1:55

5G 76

Search here



Set home

Restaurants

Coffee

Gas

80°
45 AQI

E King Ave

Opus Escrow

Simplified
Bookkeeping & Tax

Google

20 ft
10 m

Latest in the area



Explore



Go



Saved



Contribute



Updates

1:56

5G 76%

Search here

Set home

Restaurants

Coffee

Gas

Tulare County
80°
45 AQI
Mortgage Services

E King Ave

N M St

E King Ave

Opus Escrow

Simplified
Bookkeeping & Tax

N M St

son Management

Google

50 ft
10 m

Latest in the area...

Explore

Go

Saved

Contribute

Updates